

# PLATED DIAMOND AND CBN CONE WHEELS

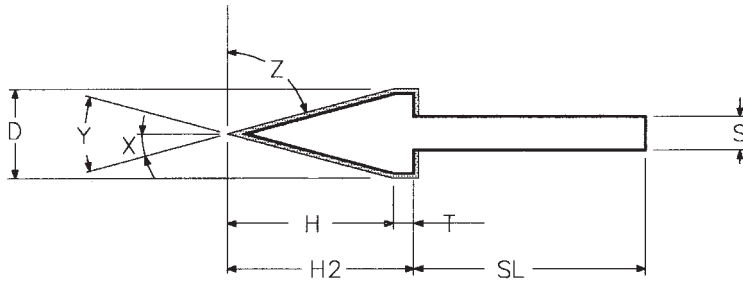

DIAMOND TOOL NO.	CBN TOOL NO.	D	Y	S	SL
PCD 4-60	PCB4-60	1/4	60	1/4	2
PCD 6-60	PCB 6-60	3/8	60	1/4	2
PCD 8-60	PCB 8-60	1/2	60	1/4	2
PCD 10-60	PCB 10-60	5/8	60	3/8	2
PCD 12-60	PCB 12-60	3/4	60	3/8	2
PCD 14-60	PCB 14-60	7/8	60	3/8	2
PCD 16-60	PCB 16-60	1	60	3/8	2
<hr/>					
PCD 4-90	PCB 4-90	1/4	90	1/4	2
PCD 6-90	PCB 6-90	3/8	90	1/4	2
PCD 8-90	PCB 8-90	1/2	90	1/4	2
PCD 10-90	PCB 10-90	5/8	90	3/8	2
PCD 12-90	PCB 12-90	3/4	90	3/8	2
PCD 14-90	PCB 14-90	7/8	90	3/8	2
PCD 16-90	PCB 16-90	1	90	3/8	2

**Number Size = Fraction**

1	=	1/16
1.5	=	3/32
2	=	1/8
2.5	=	5/32
3	=	3/16
4	=	1/4
5	=	5/16
6	=	3/8
7	=	7/16
8	=	1/2
9	=	9/16
10	=	5/8

## HOW TO ORDER

PCD
8
-
90
S=
1/4
80 Grit

Plated  
Cone  
Wheel
D=Diamond  
B=CBN
Head  
Diameter
Degree of  
Angle
Shank  
Diameter
Grit Size

**DIAMETERS:** All sizes can be manufactured.

**ANGLE:** Any angle can be manufactured.

**SHANK:** All shank diameters or lengths can be made. Carbide shanks available.

**GRIT SIZE:** Any size can be supplied

**SPECIAL SHAPES:** CDT can manufacture any shape. Please inquire.