

# DIAMOND PLATED ROUTERS

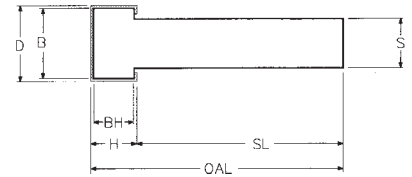
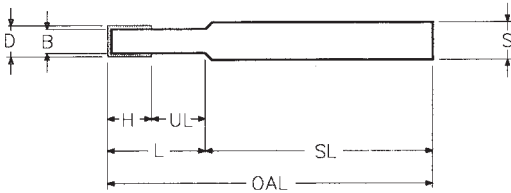

CATALOG NUMBER	DIAMETER	DIAMOND LENGTH	CATALOG NUMBER	DIAMETER	DIAMOND LENGTH
R 1/8 x 1/4	1/8	1/4	R 5/8 x 2	5/8	2
R 1/8 x 3/8	1/8	3/8	R 3/4 x 1/2	3/4	1/2
R 1/8 x 1/2	1/8	1/2	R 3/4 x 3/4	3/4	3/4
R 1/8 x 3/4	1/8	3/4	R 3/4 x 1	3/4	1
R 1/4 x 1/4	1/4	1/4	R 3/4 x 1 1/4	3/4	1 1/4
R 1/4 x 1/2	1/4	1/2	R 3/4 x 1 1/2	3/4	1 1/2
R 1/4 x 3/4	1/4	3/4	R 3/4 x 1 3/4	3/4	1 3/4
R 1/4 x 1	1/4	1	R 3/4 x 2	3/4	2
R 1/4 x 1 1/4	1/4	1 1/4	R 1 x 1/2	1	1/2
R 1/4 x 1 1/2	1/4	1 1/2	R 1 x 3/4	1	3/4
R 3/8 x 3/8	3/8	3/8	R 1 x 1	1	1
R 3/8 x 1/2	3/8	1/2	R 1 x 1 1/4	1	1 1/4
R 3/8 x 3/4	3/8	3/4	R 1 x 1 1/2	1	1 1/2
R 3/8 x 1	3/8	1	R 1 x 1 3/4	1	1 3/4
R 3/8 x 1 1/4	3/8	1 1/4	R 1 x 2	1	2
R 3/8 x 1 1/2	3/8	1 1/2	R 1 1/2 x 1/2	1 1/2	1/2
R 1/2 x 1/2	1/2	1/2	R 1 1/2 x 3/4	1 1/2	3/4
R 1/2 x 3/4	1/2	3/4	R 1 1/2 x 1	1 1/2	1
R 1/2 x 1	1/2	1	R 1 1/2 x 1 1/4	1 1/2	1 1/4
R 1/2 x 1 1/4	1/2	1 1/4	R 1 1/2 x 1 1/2	1 1/2	1 1/2
R 1/2 x 1 1/2	1/2	1 1/2	R 1 1/2 x 1 3/4	1 1/2	1 3/4
R 1/2 x 1 3/4	1/2	1 3/4	R 1 1/2 x 2	1 1/2	2
R 1/2 x 2	1/2	2	R 2 x 1/2	2	1/2
R 5/8 x 1/2	5/8	1/2	R 2 x 3/4	2	3/4
R 5/8 x 3/4	5/8	3/4	R 2 x 1	2	1
R 5/8 x 1	5/8	1	R 2 x 1 1/4	2	1 1/4
R 5/8 x 1 1/4	5/8	1 1/4	R 2 x 1 1/2	2	1 1/2
R 5/8 x 1 1/2	5/8	1 1/2	R 2 x 1 3/4	2	1 3/4
R 5/8 x 1 3/4	5/8	1 3/4	R 2 x 2	2	2

## HOW TO ORDER

R 1/2 x 1 U S x 3/8 x 2 1/2 40-50

Catalog No. U=Unfluted F= Fluted Router End S= Square B = Ball End D = Drill End P = Pilot PB = Bearing Shank Size Grit Size

- DIAMETERS:** CDT can manufacture any size required.
- SHANK SIZE:** Any diameter and length can be manufactured. For safety reasons the above listed shank diameters are always recommended. 2 1/2" long shank standard.
- TOLERANCE:** Standard tolerances are held coarse to fine grit sizes have different finishes. If you need tight tolerance CDT can hold sizes required. Very close tolerance may cost extra.
- FLUTES:** Flutes are sized per router. Sizes up to 3/4" have two flutes. 1" and larger have four flutes. Any number and size of flutes can be supplied.
- ROUTER END:** Standard ends are square. Sizes up to 3/4" are plated across face, 1" and larger have 1/8" return.
- GRIT SIZE:** Any size.